



Municipality of Port Hope

Staff Report

porthope.ca/agendas-and-minutes

Report Title: King's Field Concept Plan

Report to: Parks, Recreation & Culture Committee

Date of meeting: August 1, 2023

Report Author:

Julia Snoek, Director, Parks, Recreation and Culture

Department responsible:

Parks, Recreation & Culture

Report Number: PRC-09-23

Recommendation:

That report PRC-09-23 be received for information.

Highlights:

- As identified in the Leisure Services Master Plan (LSMP), Parks, Recreation and Culture (PRC) is reviewing several park spaces for optimization and reuse, including the parkland known as King's Field.
- In consultation with staff, a sub working group of the Parks, Recreation and Culture Advisory Committee has created a concept plan for the park.

Background:

King's Field is a neighbourhood park, located on Victoria Street South and currently has a small community baseball diamond, some trees, and a gravel loop driveway. The configuration of the park has changed due to ownership, parkland allocation, and other factors related to the Mason Homes development. The ball diamond is undersized and causes risk related to orientation to the rest of the park and neighbouring houses. The neighbourhood park has been maintained to a minimal standard until revitalization plans can be determined. Staff no longer issue permits for baseball activities at this site.

King's Field was identified as part of the Leisure Services Master Plan for opportunity to:

- review and revitalize lower quality, under-utilized ball diamonds to be removed from the active inventory and evaluated for re-purposing to other in-demand recreation amenities as part of park-specific planning exercises;
- evaluate opportunities to establish a basketball court;
- investigate opportunities for strategic parkland renewal and redevelopment, with consideration given to the recommended outdoor facilities identified in the Master Plan. Renewal and redevelopment projects should be accompanied by public

consultation, park-specific concepts, facility fit diagrams, and business planning to establish capital and operational assumptions.

A community survey was completed in 2019 which gave staff and committee a general scope of community need to begin the planning process. In 2022, a sub working group of the PRC Advisory Committee was established, and design considerations and concepts were identified for King's Field. A local landscape designer, David Noble Designs, was engaged to complete a scope of work and an artistic rendering was created by artist Jenny Duda.

In the Spring of 2023, the circulation of the concept plan and rendering was completed through a small radius mailout and broader community consultation via the MyPortHope.ca community engagement website.

The receipt of comments by staff and PRC Advisory Committee resulted in a revision and an updated concept.

Discussion:

From the MyPortHope page there were:

- 462 page visits
- 128 people participated in the quick poll

Staff also received 53 email comments.

The summary of comments and quick poll are generalized below:

- Significant number of concerns and opposition to a large pavilion or shade shelter
- Strong desire for continued sport options and open space
- Significant appreciation for enhanced tree planting
- High interest in a loop trail
- Some interest in a community garden program
- General support for Victoria Street improvements and rain garden
- Some divisiveness as to why the park is under review relating to use, potential noise vs passive space
- Significant number of requests for a playground and splash pad
- More than 65% of quick poll respondents indicated they would use the park daily or weekly

In response to the above, and balancing the recommendations of the Leisure Services Master Plan, the working group and staff discussed and prepared an updated concept plan with the following considerations:

- Installation of a small gazebo, to allow for a resting space and passive use
- Removal of the ball diamond and back stop: this area is now too small to safely maintain a sports field. The municipality intends to upgrade a small community diamond at Lions Park

-
- Installation of a community basketball court - (Note that this amenity requires further planning and consultation relating to orientation, location and other impacts including noise reduction, lighting, etc.)
 - A Community Garden Program will be reviewed and developed in the future by PRC Advisory Committee
 - Based on planning and radius best practices a playground is not required nor recommended at this site. Neighbouring Bigwood Park and Commons Park currently host playground facilities. A splash pad is not in the long-term plans for installation in a neighbourhood park but may be considered for other community park spaces (example: waterfront).

For consideration, staff and the PRC Advisory Committee observed a significant neighbourhood divide relating to the assumptions of population demographics in the area of King's Field. There is a considerable "older adult" vs "young family" assumption in this area which was reflected in the majority of comments received. Staff note that there is a mix of demographics in this area and has taken this balance and "opportunity for all" into consideration during creation of the concept plan.

At the regular meeting of June 21, 2023, the working group presented the updated concept plan, and the PRC Advisory Committee made the following motion:

PRC 16/2023

Moved by F. Langmaid

Seconded by G. Ryan

That the Parks, Recreation and Culture Advisory Committee approves in principle the concept design (item 2: with basketball court) with any further consultation, phase-in over time and based on budget.

CARRIED

Based on the recommended updates, all details have been updated and added to the [MyPortHope engagement site](#) as summarized above.

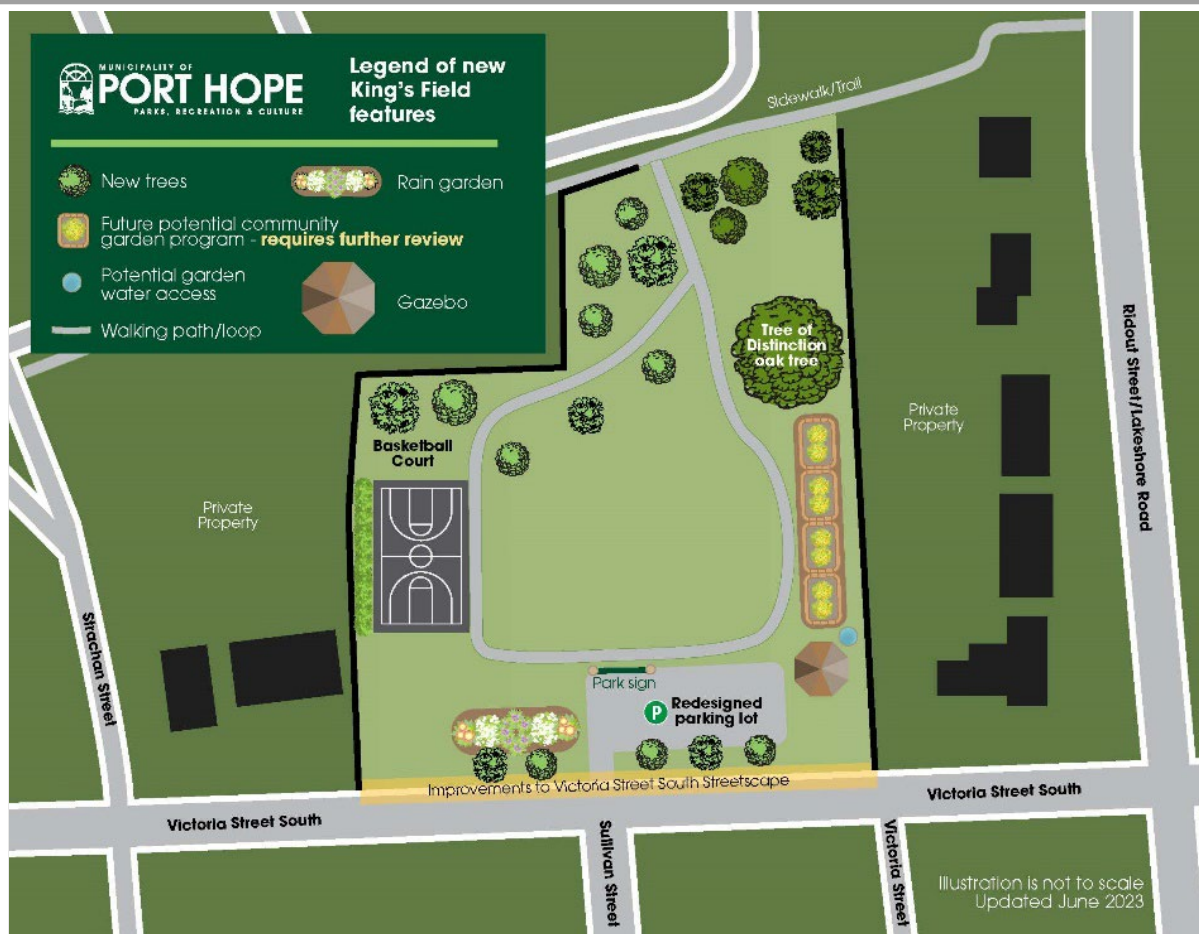

Figure 1 A map of King's Field concept plan- updated June 2023

Financial Considerations:

With efforts to maximize use, provide unique opportunities for the neighbourhood and investment in parks and trees, the concept plan is anticipated to be implemented in the near-, mid- and long-term and all components are pending future approved budgets.

Communication and Public Engagement:

Previous communications efforts relating to the draft concept plan were shared via MyPortHope.ca and a short range mailout to the neighbourhood. Emails were sent to contacts who had submitted comments to staff with the updated concept. There is no further community consultation required for this site at this time, until details relating to the potential basketball court progress further.

Conclusion:

The development of the concept plan for King's Field Park has been completed and recommended by the Parks, Recreation and Culture Advisory Committee. This project

is a strategy included in the Leisure Services Master Plan and aligns with the proposed Multi-Generational Community Opportunities priority of the strategic Plan.

Attachments:

None.